

BourdonTube Pressure Gauges

Bayonet Ring Case Stainless Steel,
DW-Line (Double Weld)

RCh 100-3vDW
RChG 100-3vDW

Standard Versions

Information on general and metrological features (load limits / temperature limitations) and standard pressure ranges / scale divisions can be found in model overview 1000.

Accuracy (EN 837-1)

Class 1.0

Case

Bayonet ring, 1.4301 (304 stainless steel)

Case Protection Type (EN 60 529 / IEC 529)

IP 54

IP 65 for model RChG

Blow-out Device

Model RCh Blow-out plug in the back of the case,
1" (Ø 25mm)
Model RChG 100 Blow-out plug in the back of the case,
1½" (Ø 40mm)

Case Ventilation

Model RChG, without ventilation, but with internal pressure compensation by pressure equalizing membrane.

Case Filling

for model RChG: glycerine

Nominal Case Size

100 (mm) (4")

Wetted Parts

Connection: 1.4571 (316 stainless steel)
Bourdon Tube: 1.4571 (316 stainless steel),
argon arc welding,
≤ 40 bar (600 psi) c-form,
≥ 60 bar (800 psi) helical

Case Configuration

Connection: welded
Position of the connection: bottom connection,
optional lower back connection (r)

Pressure Ranges (EN 837-1)

0-0.6 bar (0-10 psi) to 0-250 bar (0-3,000 psi)

Process Connection

Connection piece d8 x 5
for welding at the chemical seal

Window

Laminated safety glass

Movement

Stainless steel

Dial

Aluminum, black figures, white background

Pointer

Aluminum, black

Safety Category according to EN 837-1

S1 pressure gauges with blow-out device



NEW DW-Line (Double Weld)

Pressure gauges RCh/RChG 100-3vDW (case / connection piece welded) welded with chemical seal MDM 7...v

Ordering Information, Standard Pressure Ranges, Options:

see pages 3 and 4

Special Versions and further Options among others

- Other pressure ranges and / or special scales, e.g. double scale bar/psi, coloured fields or areas, dial inscriptions, negative scale etc.
- Pressure ranges > 250 bar (3,000 psi) upon request
- Stationary red pointer with window made of polycarbonate or laminated safety glass upon request
- Min.- or max.-drag indicator upon request
- Case parts 1.4404 (316 L stainless steel) upon request
- Increased case protection type, e. g. IP 65 without case filling, upon request
- Other case fillings upon request
- Model RChG for ambient temperatures down to -40 °C (-40 °F) upon request
- Position of connection radial at 3 o'clock, 9 o'clock or 12 o'clock (others upon request) or other than vertical installation (90°)
- GOST-version for Russia, Ukraine, Kazakhstan

Accessory:

Chemical seals, sealings,
process connection pieces: see catalogue-heading 7
Electrical: limit switch contact assembly
DS 1291 and catalogue-heading 9.1



Sales and Export South, West, North

ARMATURENBAU GmbH

Manometerstraße 5 • D-46487 Wesel - Ginderich
Tel.: +49 (0) 28 03 / 91 30-0 • Fax: +49 (0) 28 03 / 10 35
armaturenbau.com • mail@armaturenbau.com

Subsidiary Company, Sales and Export East

MANOTHERM Beierfeld GmbH 1201.7

Am Gewerbepark 9 • D-08344 Grünhain-Beierfeld
Tel.: +49 (0) 37 74 / 58-0 • Fax: +49 (0) 37 74 / 58-545
manotherm.com • mail@manotherm.com

11/09

Case Configuration, Code Letters, Dimensional Data and Weights, Blow-out Device

Bottom connection

No mounting device

(no additional code letters)

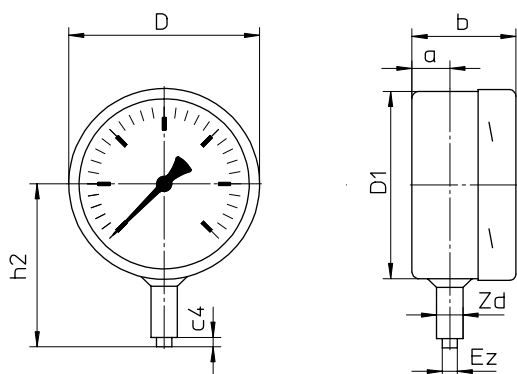

Lower back connection

No mounting device

code letter: r

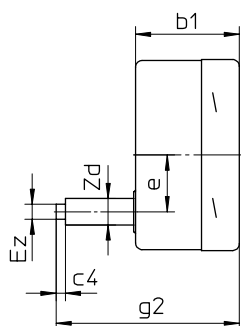

Dimensional data (mm / inches) and weight (kg / lb)

NCS	a	b	b1	c4	D	D1	e	Ez	g2	h2 ⁺¹	Zd ^{+0,5}	approx. Weight	
												RCh	RChG
100	20	55	55	5	101	99	30	8	97	86	14	0.45	0.80
4"	.79	2.17	2.17	.20	3.98	3.90	1.18	.31	3.82	3.39	.55	.99	1.76

Blow-out device

Blow-out plug

- Ø 1" (25 mm) for model RCh 100
- Ø 1½" (40 mm) for model RChG 100
- with pressure equalizing membrane

